



HOUSE OF LORDS



02

INTRODUCTION

A brief introduction to the history of the House of Lords...

03

CHOLOMONDELEY

10

KITCHEN

11

FLOWERS

12

AV PACKAGES

13

GIFT SHOP

14

TOURS

16

CONTACT US

08

ATTLIE ROOM

09

HOME ROOM

DOORKEEPER

15

ACCESS



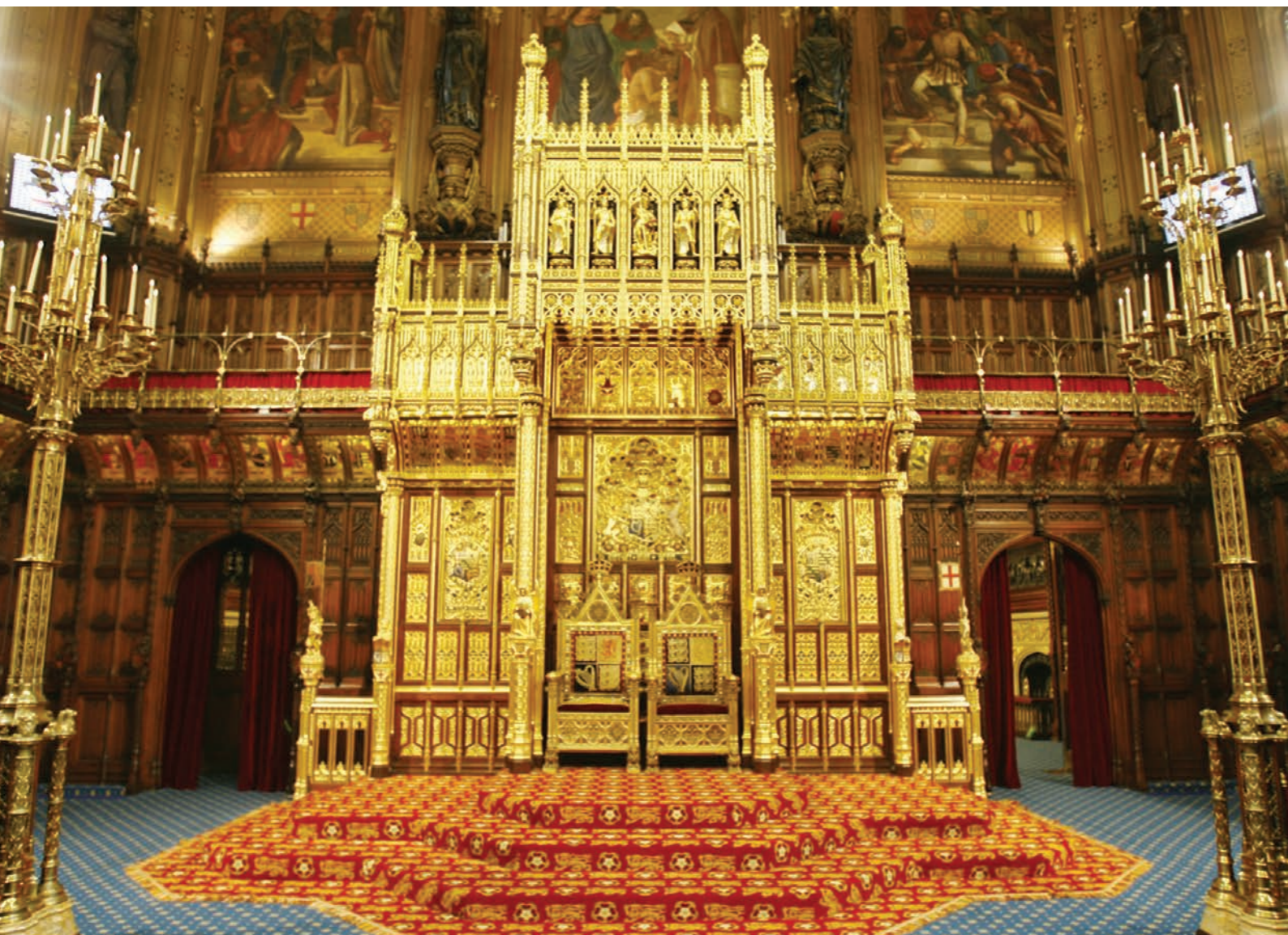

AN INTRODUCTION TO THE HOUSE OF LORDS

Both Houses of Parliament have met at Westminster since they first came into being in the 13th and 14th centuries. Westminster Hall dates from the end of the 11th century.

The rest of the old Parliamentary buildings were destroyed by fire in 1834 and the present Palace of Westminster was built between 1840 and 1860. The House of Lords first occupied its Chamber in 1847.

A competition was held for the design of the new building and the winner was the gothic design of Mr (later Sir) Charles Barry. The internal decoration and furniture are largely the work of Barry's assistant Augustus Pugin. A Royal Commission chaired by Prince Albert oversaw the commissioning of paintings and sculptures in most of the main rooms.

The House of Lords occupies the southern part of the Palace of Westminster. The House normally meets on around 150 days each year, sitting for about 1,000 hours in total. About half of the time of the House is spent discussing legislation.

The House also debates issues of public policy and scrutinises the Government through questions to ministers, of whom over 20 sit in the House of Lords. In addition to sittings in the Chamber, much work is

done in committees meeting in nearby committee rooms, mostly on the first floor overlooking the River Thames.

The House has over 800 members. On average over 400 attend each daily sitting. Most members are Peers appointed for life.

In addition there are 92 hereditary Peers and 26 Archbishops and Bishops of the Church of England.

From buffets and cocktail parties to banquets, the House of Lords is complimented for the excellent service given by its in-house team and for the efforts it makes to meet each organisation's needs. Rooms are laid with House of Lords crested silver and crockery, and floral displays and menus can be included to add that touch of splendour.

One of the most iconic buildings in the world, no other venue is more instantly recognized than the Palace of Westminster. It is impossible to walk through its corridors or dine in its imposing function rooms without a deep sense of awe. With a dedicated team to support you from the initial planning stage through to your event, your guests will have an unforgettable experience at The House of Lords.

THE CHOLMONDELEY ROOM AND TERRACE

The Cholmondeley Room adjoins the Terrace with its stunning views of the River Thames. The room came into operation in June 1963. It was given the name "Cholmondeley" after the 5th Marquess of Cholmondeley who, as Lord Great Chamberlain, recommended that Peers should have a room to entertain guests privately.

The Cholmondeley Room was originally three library stores with adjoining corridors. The Cholmondeley Room itself is used for pre-luncheon or dinner drinks.

The Terrace, located right on the north bank of the River Thames, can seat between 50 to 120 guests comfortably for sit-down lunches and dinners. Alternatively the Terrace can be used for receptions and cocktail parties. It can be prepared to accommodate between 100 and 250 guests.

The wallpaper was designed by Augustus Welby Pugin who collaborated with Charles Barry to produce Gothic Revival designs throughout the building. The letter 'R' and the chained White Hart or deer were the symbols of King Richard II who commissioned the great hammer-beam roof in Westminster Hall.

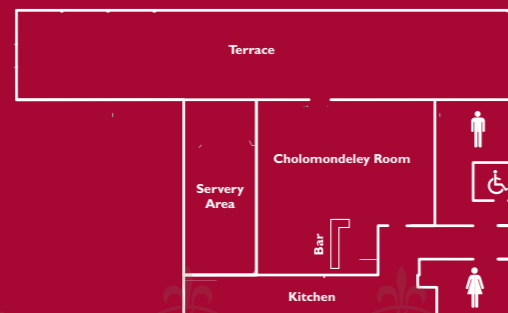

The east front of the Palace is 265.7m (872ft) from end to end and is the longest façade of any building in London and the River Terrace itself is 206.6m (678ft) long. The coats of arms of the sovereigns from William the Conqueror to Queen Victoria are displayed in carved stone at principal floor level. By 1900 the Terrace was popular for Members to take ladies out for tea and has since been developed for full dining.

ROOM DIMENSIONS

15.3 x 8.4m

31.75 x 5.7m (terrace)

SEATED

Rounds 120

STANDING

Reception 250







THE ATTLEE ROOM



The Attlee Room is named after Clement Attlee, 1st Earl Attlee who was Labour Prime Minister at the beginning of the 'Atomic Age' from 1945 to 1951. His Government was responsible for nationalising key industries and establishing the Welfare State.

The Attlee Room overlooks the River Thames and Black Rod's Garden with furniture commissioned from the Viscount Linley.

The Attlee Room is a delightful place for lunches, afternoon teas and dinners. There is seating for 16 to 38 people (30 to 60 standing) in comfortable surroundings in this elegant and gracious room.

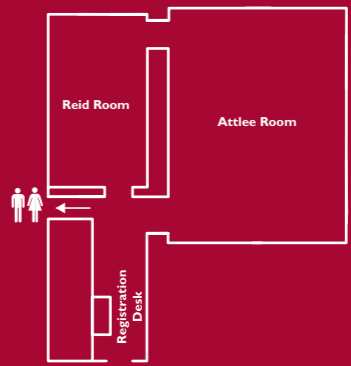

ROOM DIMENSIONS	
6.75 x 9.25m	
SEATED	
U shape	42
Long	24
STANDING	
Reception	60

THE HOME ROOM

The Home Room overlooks the River Thames to the East and the Terrace to the North. The room is named after Alec Douglas-Home (1903-1995), Baron Home of the Hirsel who was Prime Minister from October 1963 to October 1964 following the resignation of Harold Macmillan. The furniture was commissioned from the designer David Armstrong-Jones (Viscount Linley, son of the late Princess Margaret).

The Home Room can comfortably accommodate guests for lunches, afternoon teas and dinners with seating for 12-20 people (20-40 standing). During favorable summer months the adjoining Terrace can accommodate guests for pre-luncheon and dinner drinks.

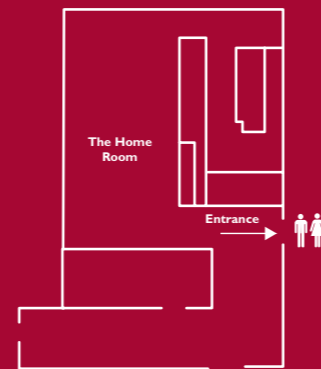

ROOM DIMENSIONS

4.45 x 9.25m

SEATED

Long table 22

STANDING

Reception 40

KITCHEN

Our experienced kitchen team take as much pride in catering for your event day as they do for state occasions hosted here at the House of Lords. Creating seasonal menus with quality ingredients and impeccable attention to detail you can be assured that your guests will be wowed at every course.

From canapés to fine dining we have a variety of catering options to suit your timings and budget. Our selection of venues offer the perfect setting to suit your menu, whether it be a Champagne reception on our riverside Terrace, a traditional 'British' afternoon tea in the elegant Attlee Room or an intimate dinner in the Home Room.

You can relax in the knowledge that our team will deliver a sumptuous menu with exemplary service.



FLOWERS

Whatever your chosen theme we can organise flower displays to suit. We can provide table centre pieces from £35 each (incl. VAT) or pedestal displays from £125 each (incl. VAT). Get in touch if you want more custom tailored arrangements for your Event and we will organise a quote.

You can be sure we will infuse your Event with character and emotion inspired by you and brought to life by our florist. Speak to our event coordinators for further information and prices.



AV PACKAGES

Our in-house service partner, Bowtie TV, has provided specialist digital AV equipment and digital language facilities to the Houses of Parliament and other public sector clients for many years. We can provide high-quality specialist audio-visual equipment coupled with technical expertise dedicated to making your event a success.

DOORKEEPER

A Door Keeper will be provided where appropriate for all functions (excluding breakfasts) in the Cholmondeley Room & Terrace and Peers' Dining Room only. Their duty is to welcome guests on arrival to the function room and assist with setting up the PA system and introduce key speakers at your event.

HOUSE OF LORDS GIFT SHOP

The House of Lords Gift shop is located on the Ground Floor adjacent to our function rooms.

The shop stocks a wide selection of exclusive merchandise and goods may be ordered in advance for delivery to your event.

Many products can be personalised, please contact the shop on 0207 219 5168 for more details.

A small selection of our merchandise is available on line www.shop.parliament.uk

Opening hours are Monday to Thursday 11am - 8pm and Friday 11am - 3pm. By arrangement the shop can open to coordinate with your event where a minimum spend of £350 applies.



EXPLORE THE HISTORIC PALACE OF WESTMINSTER

Guided tours of the Houses of Parliament offer a unique combination of one thousand years of history, modern day politics, and stunning art and architecture. Find out how Parliament works as you travel through the Commons Chamber and the Lords Chamber, follow in the footsteps of the Queen at the State Opening and be inspired by Westminster Hall which is almost 1000 years old.

Tours may be offered alongside an event, dependant on the time of year and capacity. The Tours Office will provide guides for groups of 25 pax for a fee. They are also able to advise you as to which areas are available on any given day or date.

To discuss or arrange tours:
Events booked with a sponsoring peer –

Contact Central Tours Office

T. (020) 7219 3003 | **E.** tours@parliament.uk for further details.

Events booked with NO sponsoring peer –

Contact Commercial Tours Booking Team

T. (020)

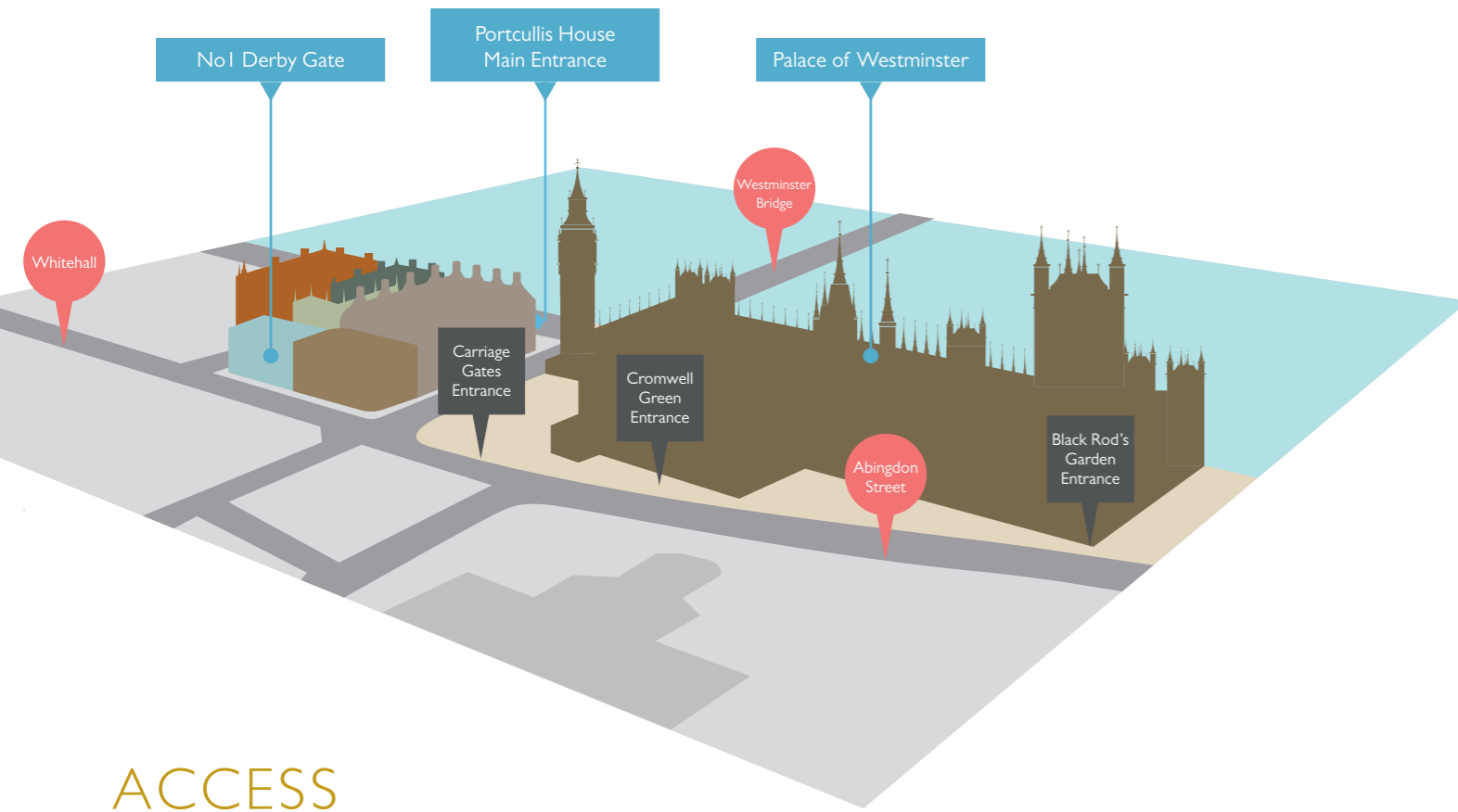

ACCESS

The Houses of Parliament are located in the heart of Westminster in the centre of London (postcode SW1A 0AA), and are well served by all forms of public transport.

Arriving by rail The nearest stations are Charing Cross, Waterloo and Victoria (15-20 minutes walk). Arriving by underground Westminster Station (Circle, District and Jubilee lines).

Arriving by bus 3, 11, 12, 24, 53, 87, 88, 148, 159, 211, 453, N2, N11, N87, N136, N155, N159 and N381 all stop nearby.

Accessibility We welcome all visitors to Parliament and continue to work to improve accessibility. All our venues are accessible by wheelchair users.

CONTACT US

Banqueting Office
House of Lords
London
SW1A 0PW

 HoLBanqueting@parliament.uk

 **0207 219 3356**



